

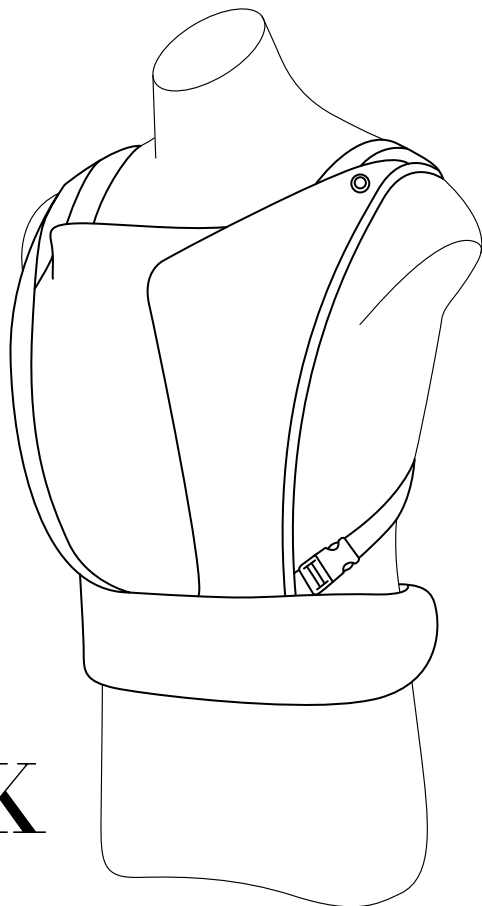

[www.cybex-online.com](http://www.cybex-online.com)







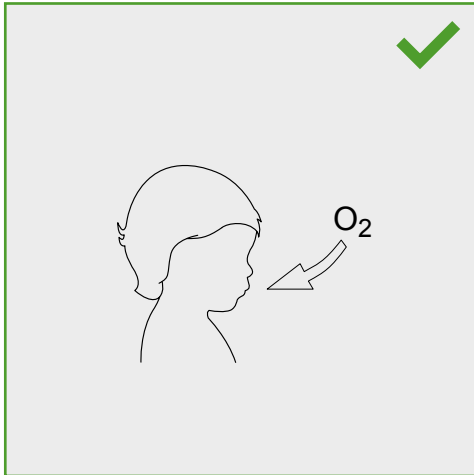
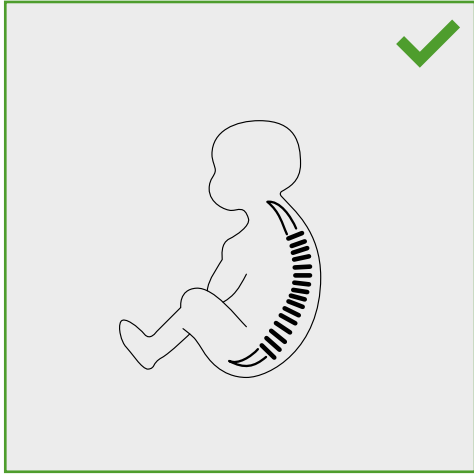

# YEMA CLICK

## BABY CARRIER



# INDEX

---

	Settings – Adjusting the Panel	4
	Settings – Using the Waist belt	8
	Settings – Using the Headrest	11
	Settings – Hide Sternum Strap for crossed carrying	14
	Front Carry Crossed – Put in the baby	16
	Front Carry Crossed – Take out the baby	22
	Front Carry Parallel – Put in the baby	24
	Front Carry Parallel – Take out the baby	31
	Back Carry – Put in the baby	33
	Back Carry – Take out the baby	38
	Hip Carry – Put in the baby	42
	Hip Carry – Take out the baby	48

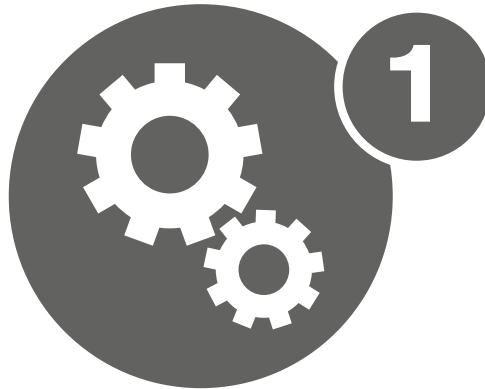

# SETTINGS

ADJUSTING THE PANEL

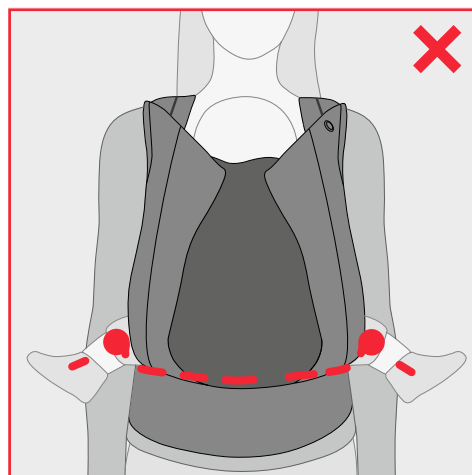
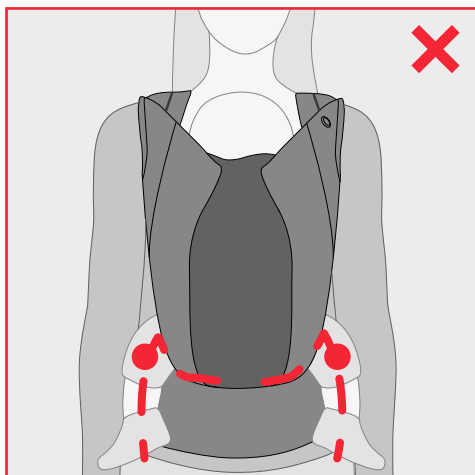
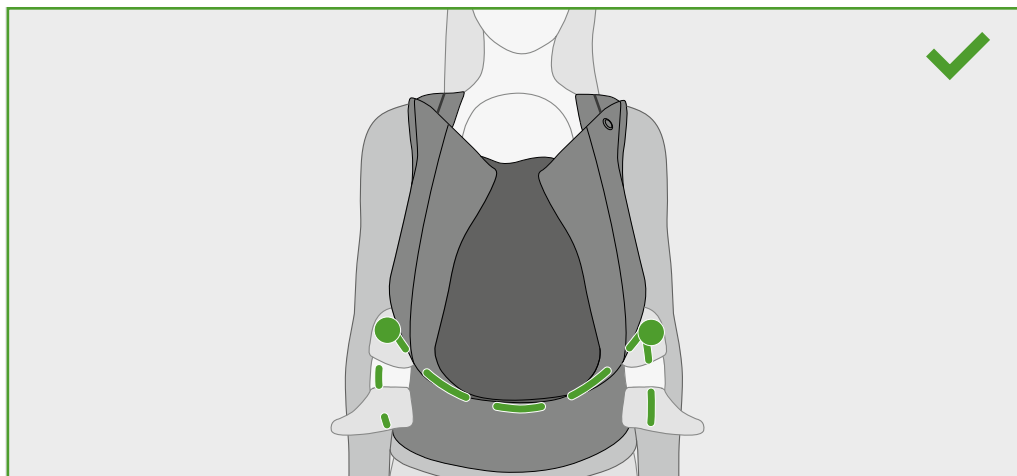

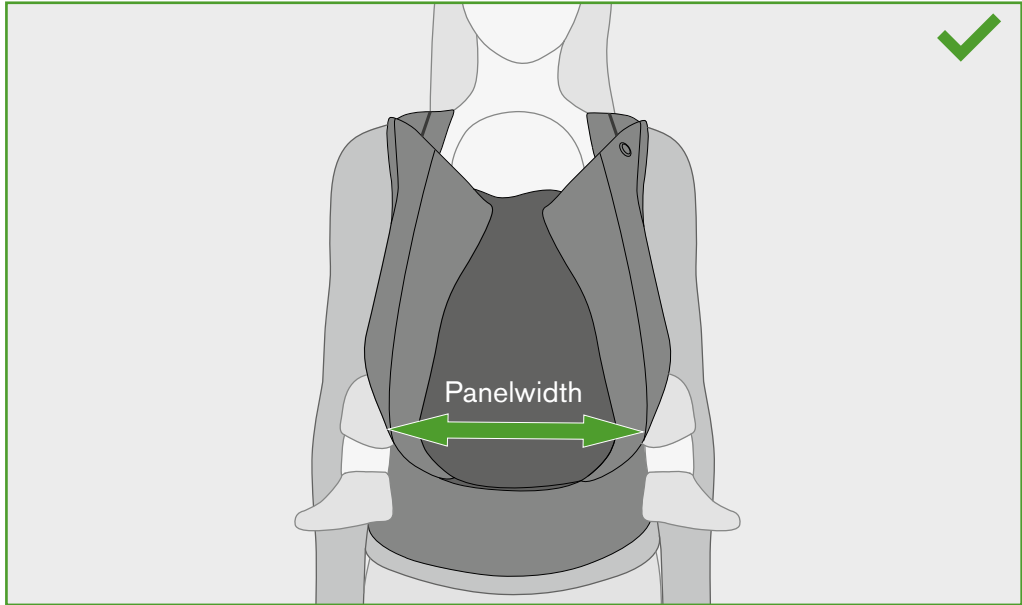

Age	Size (length)	Recommended Panelwidth	Panel adjustment
Newborn - 1month	50 - 56 cm	18 - 27 cm	0 - 1 m
1 -5 months	56 - 62 cm	27 - 32 cm	1 m - 5 m
5 - 12 month	62 - 74 cm	32 - 37 cm	5 m - 12 m
12 months - 18 months	74 - 80 cm	37 - 40 cm	12 m - 18 m
> 18 months	> 80 cm	40 - 42 cm	> 18 m

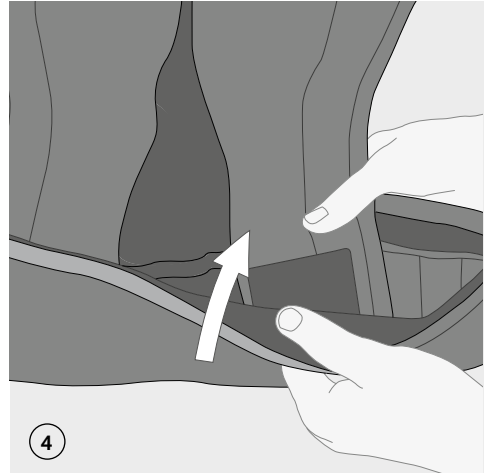
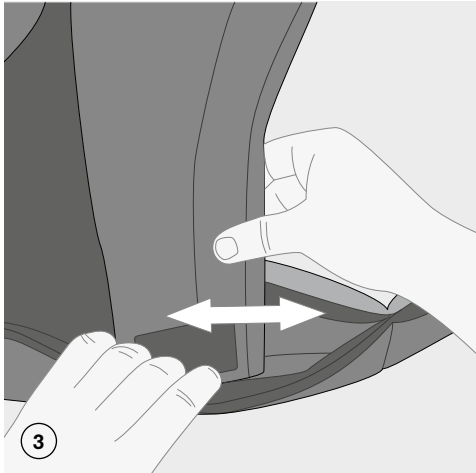
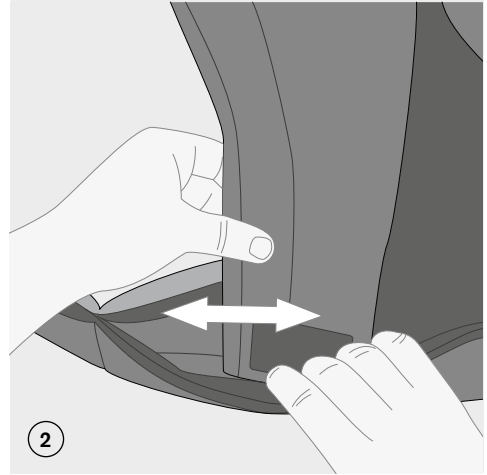
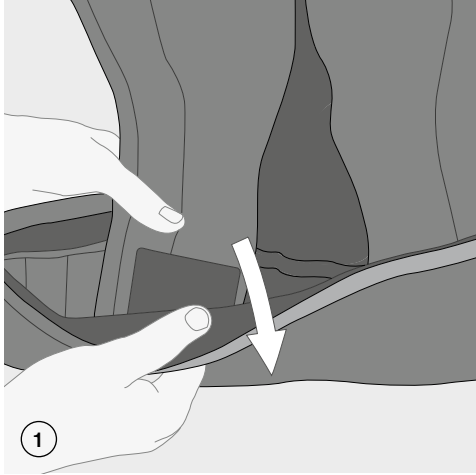



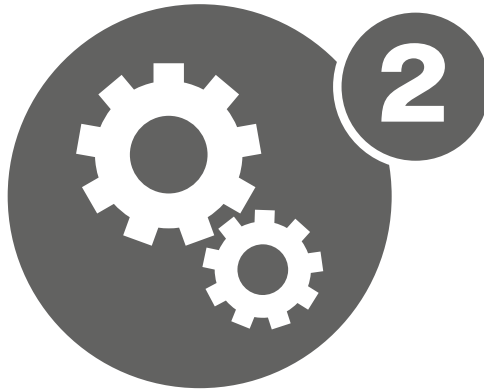

# **SETTINGS**

USING THE WAIST BELT

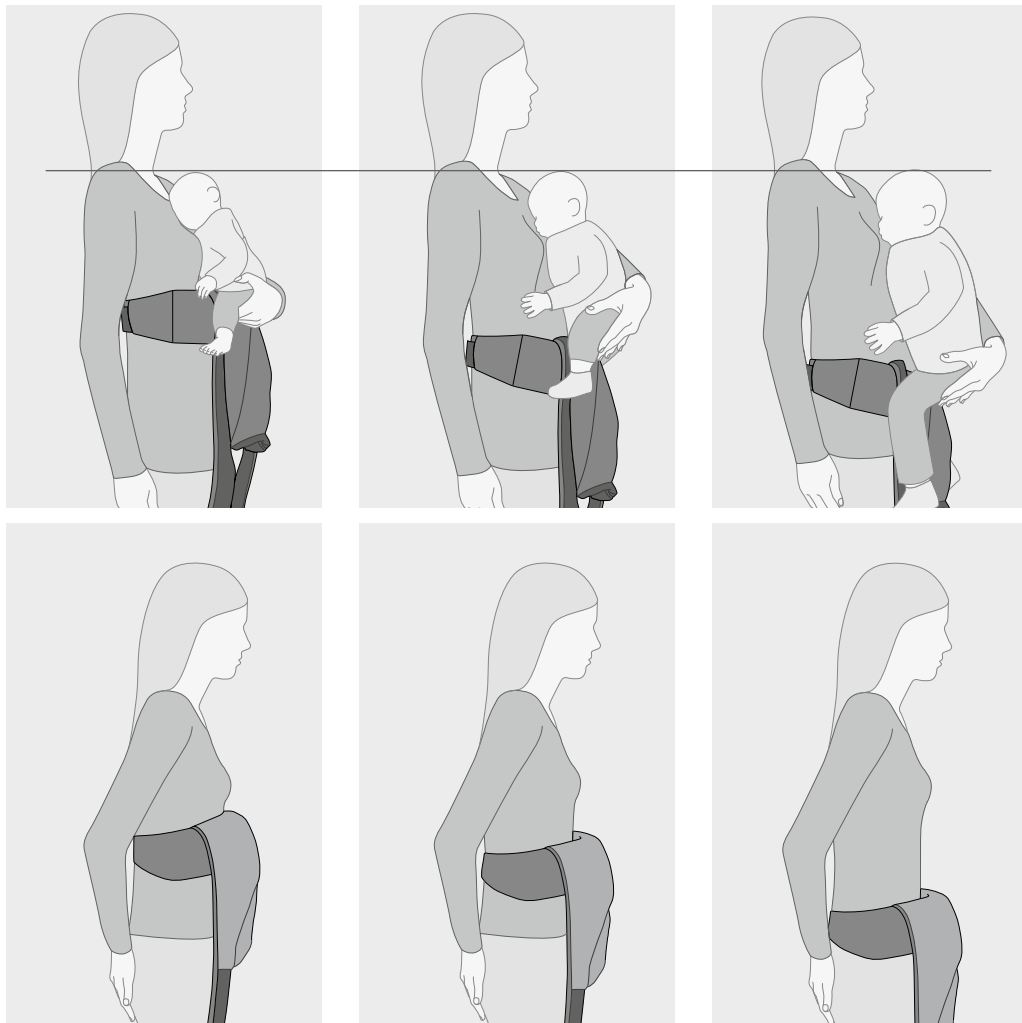

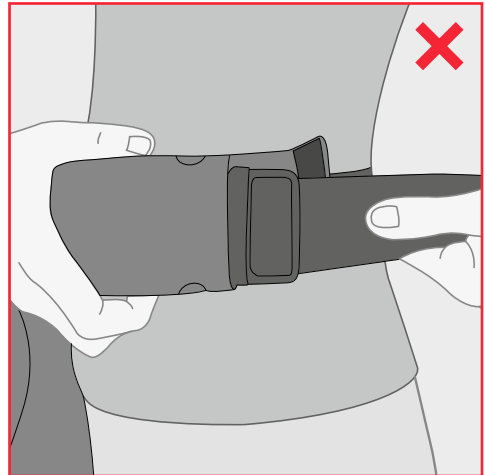
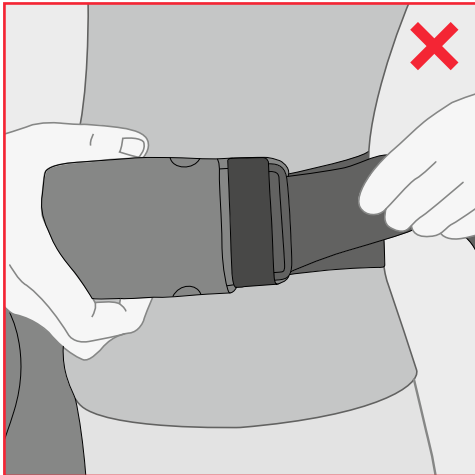
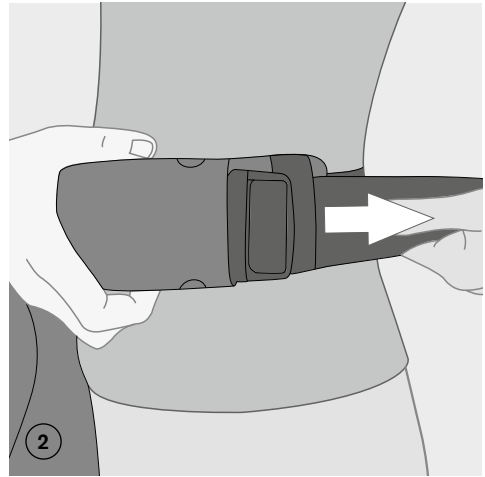
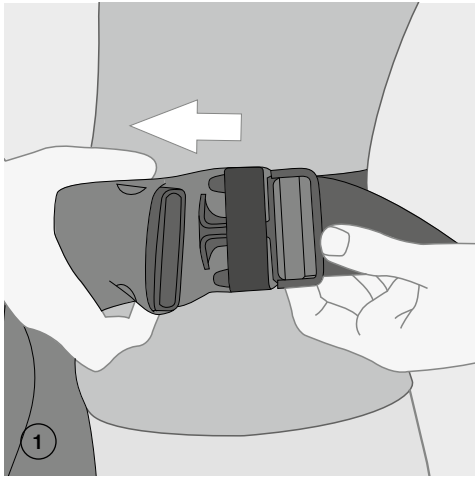

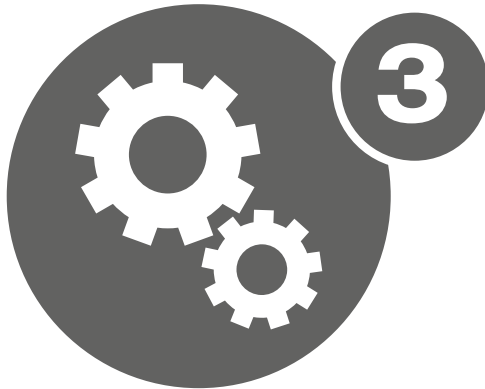

# SETTINGS

USING THE HEADREST

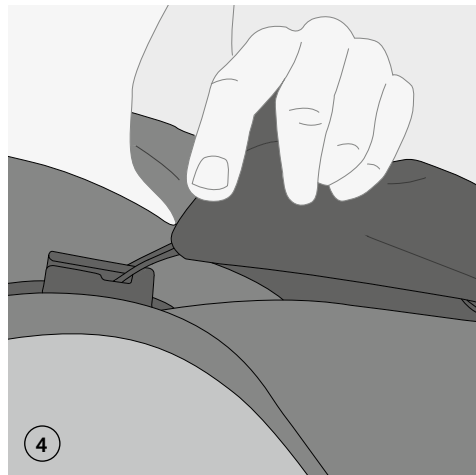
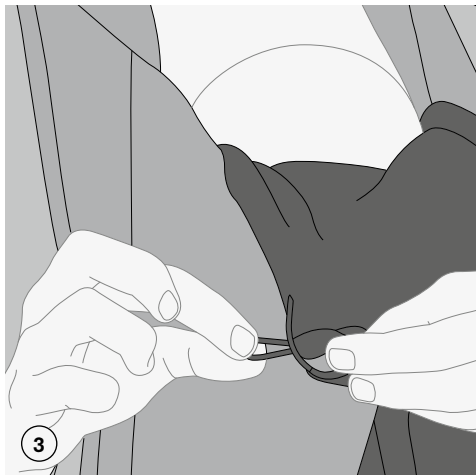
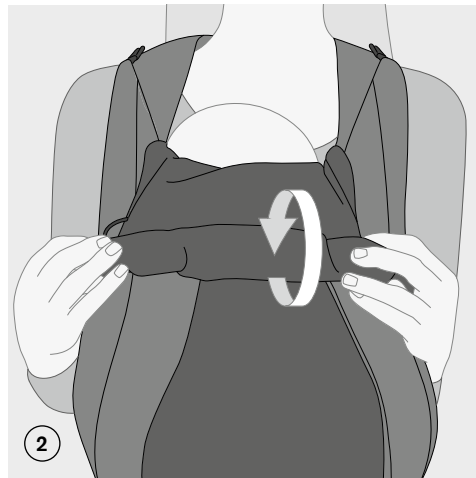
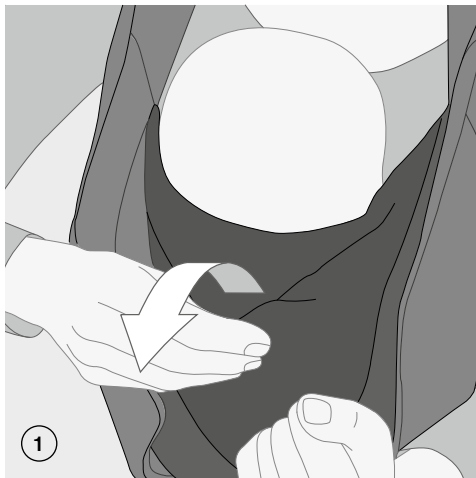

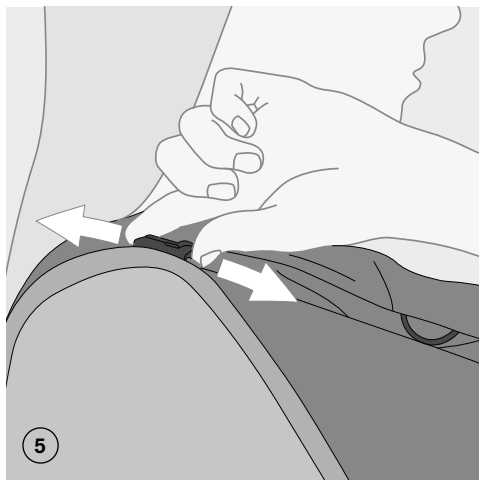

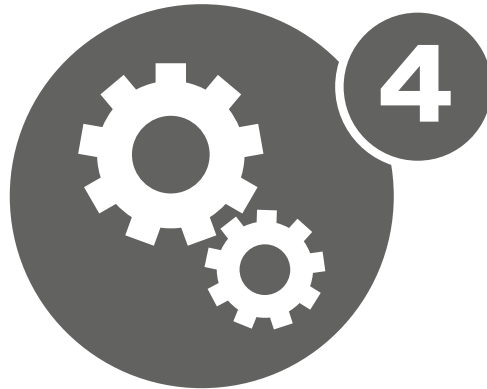

# SETTINGS

HIDE STERNUM STRAP FOR CROSSED CARRYING

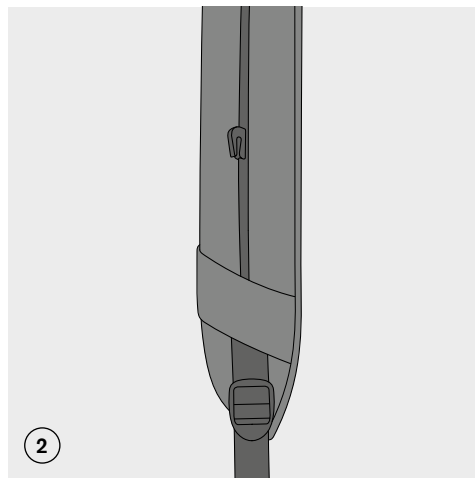
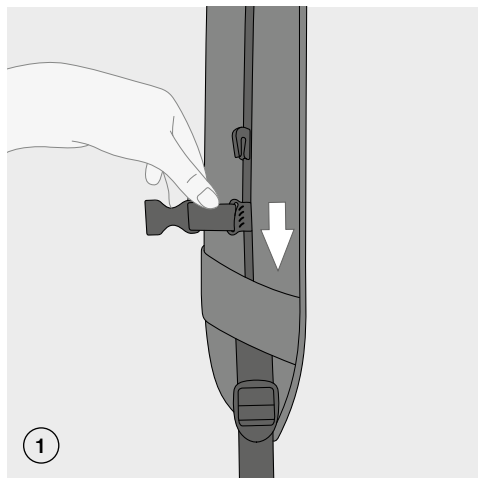



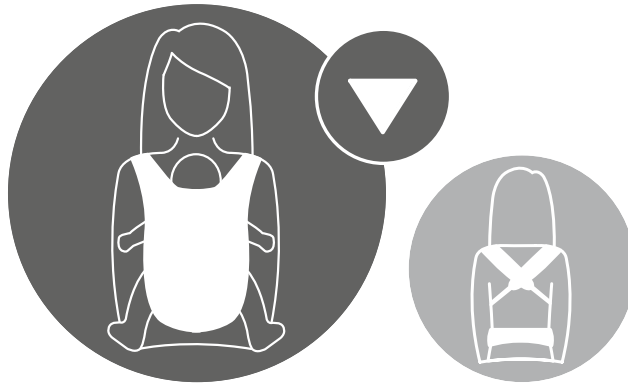

# **FRONT** CARRY CROSSED

PUT IN THE BABY

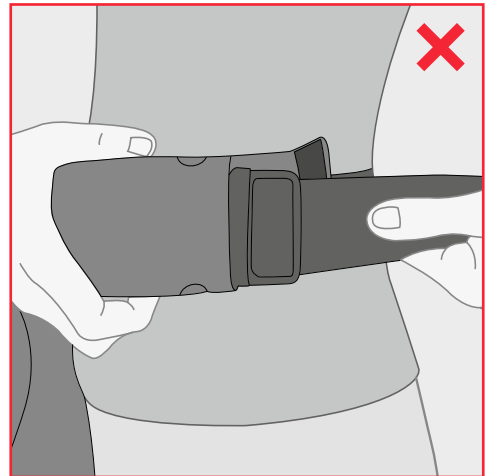
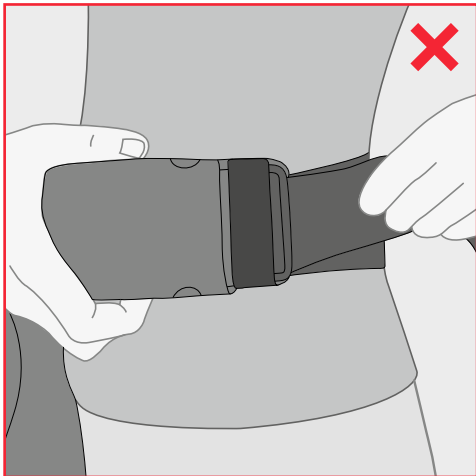
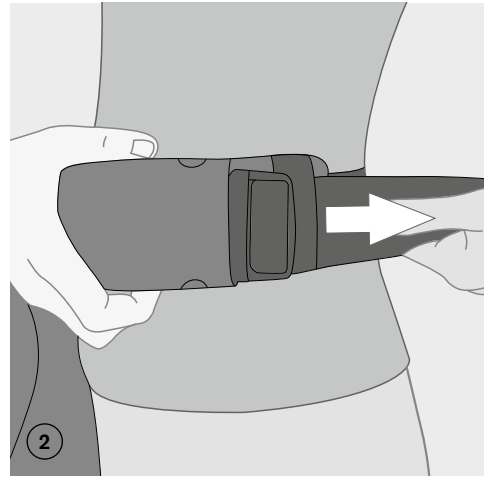
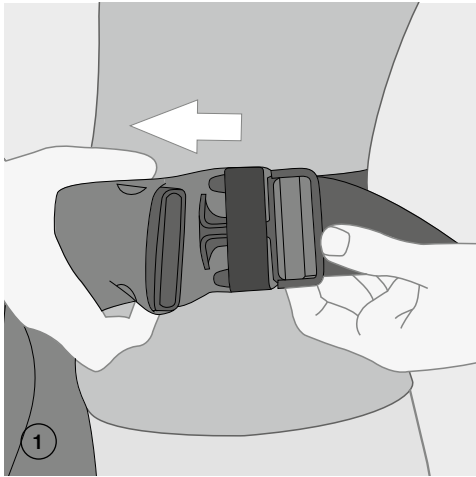

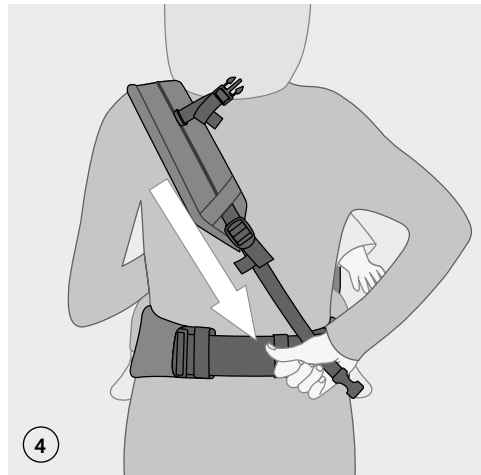
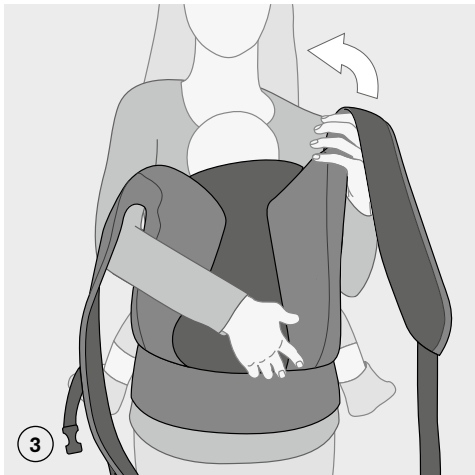
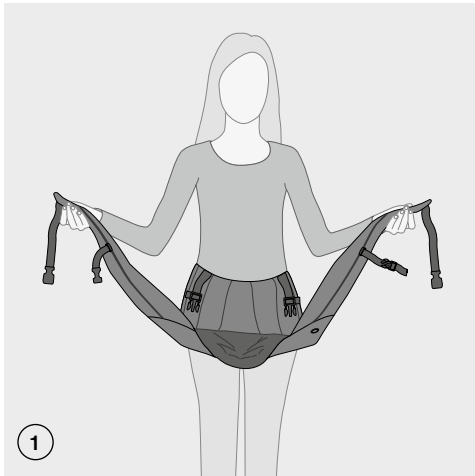

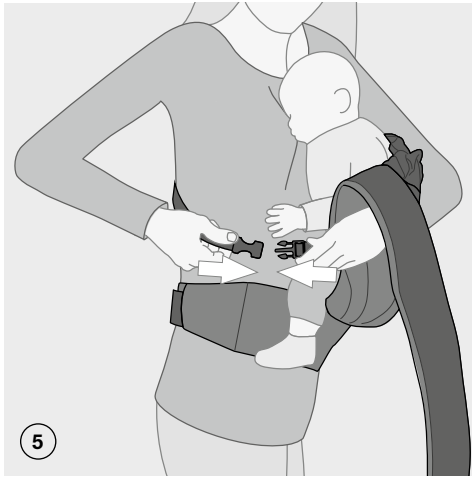

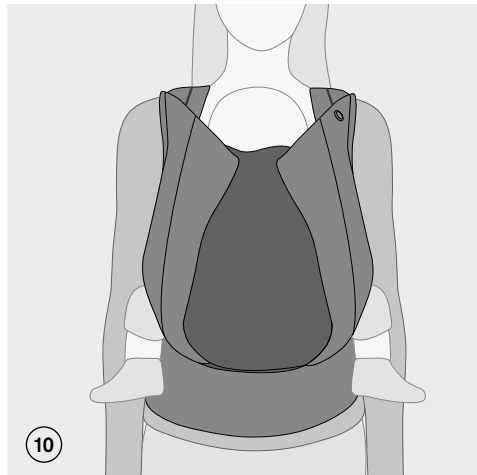

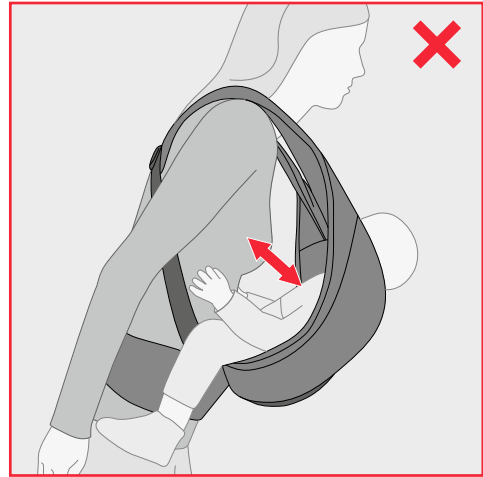

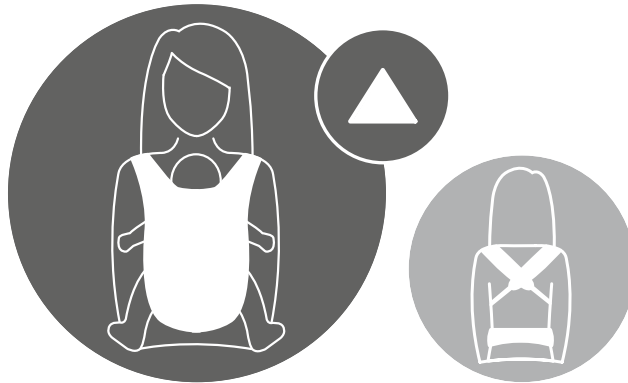

# **FRONT** CARRY CROSSED

TAKE OUT THE BABY

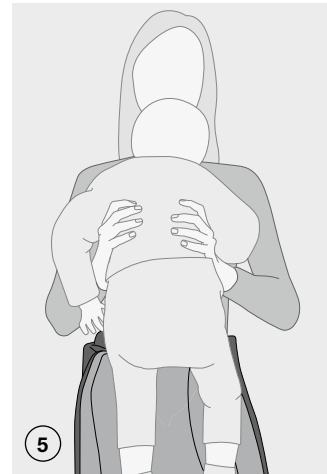
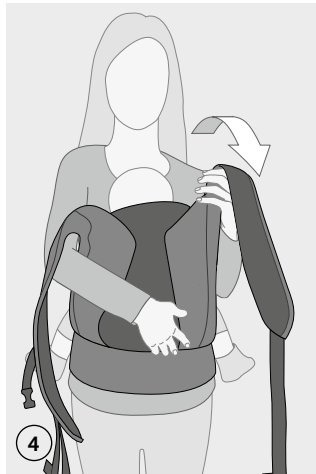
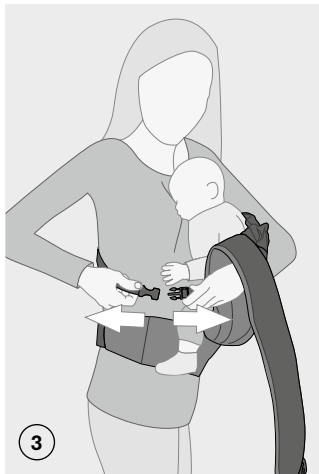



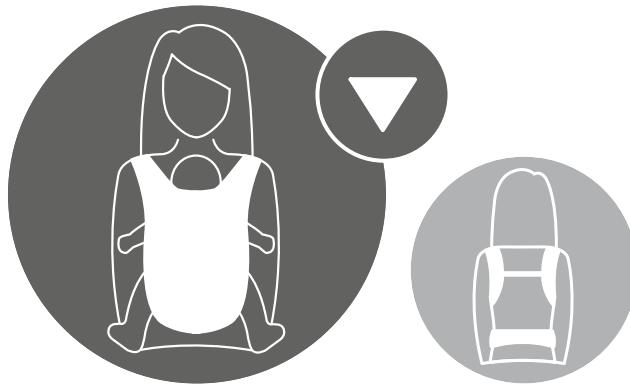

# **FRONT** CARRY PARALLEL

PUT IN THE BABY

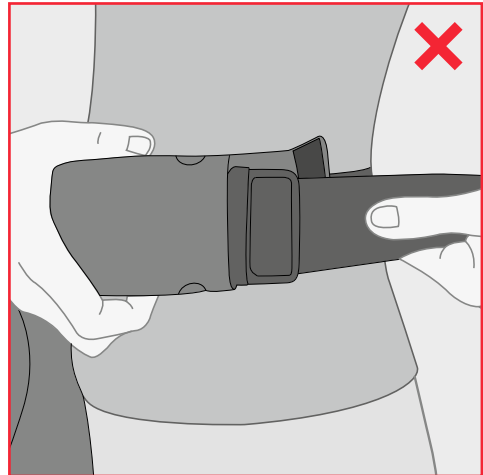
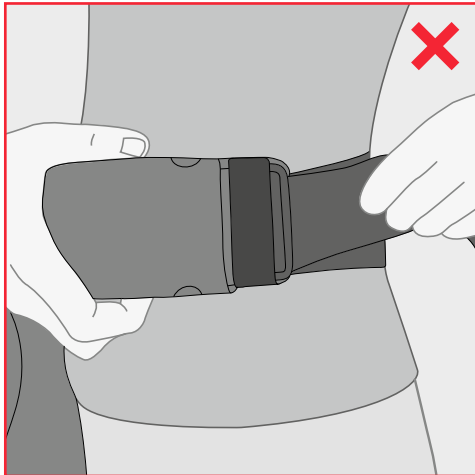
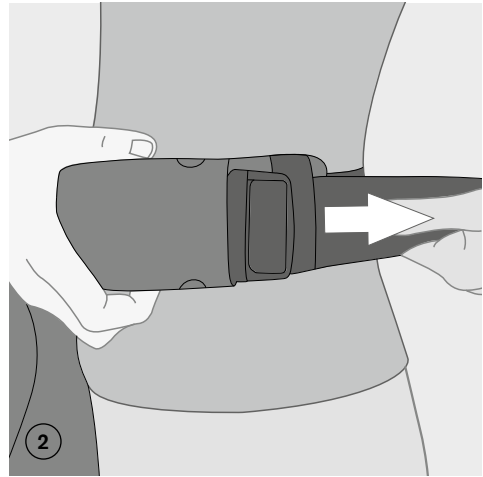
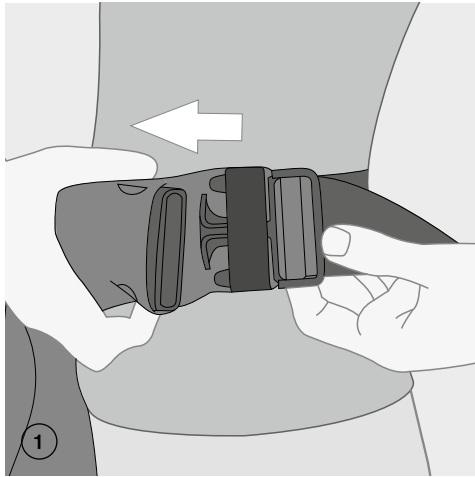

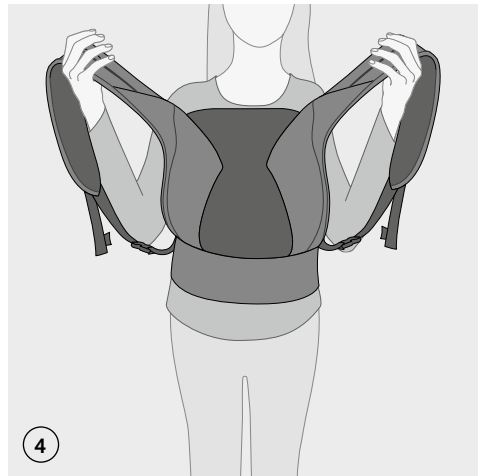
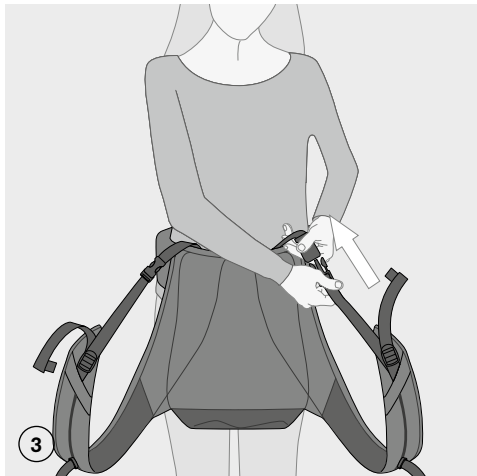
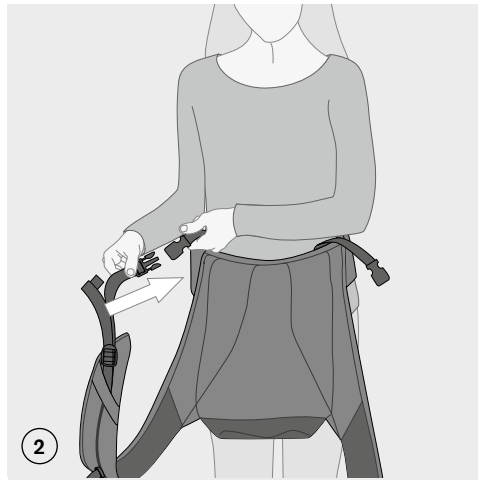

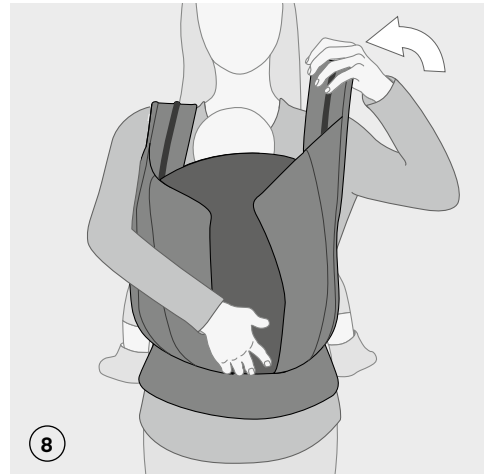
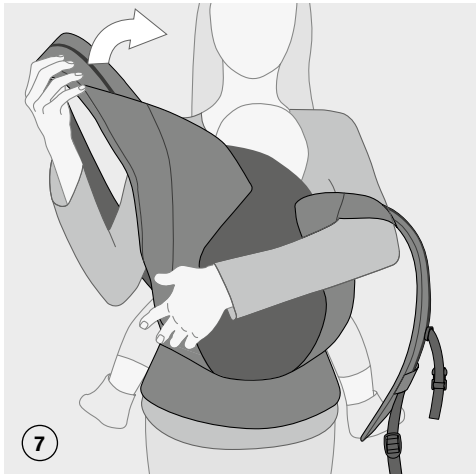

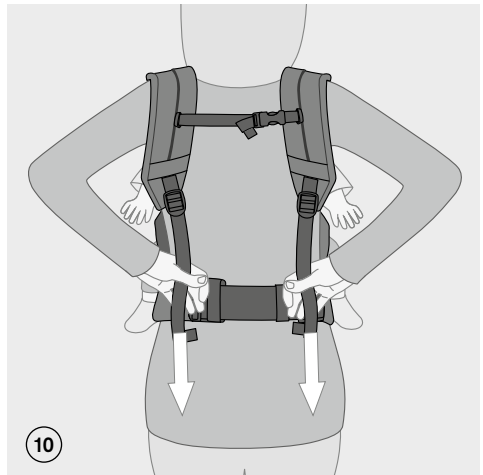
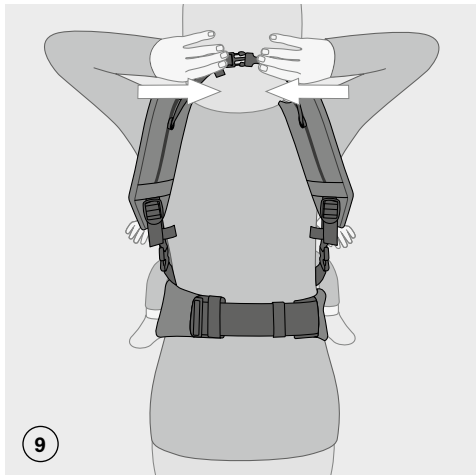
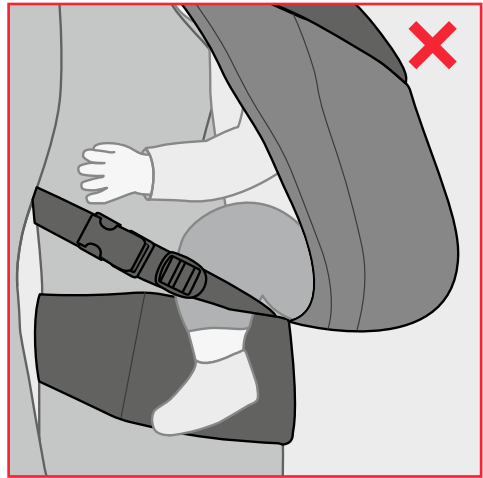
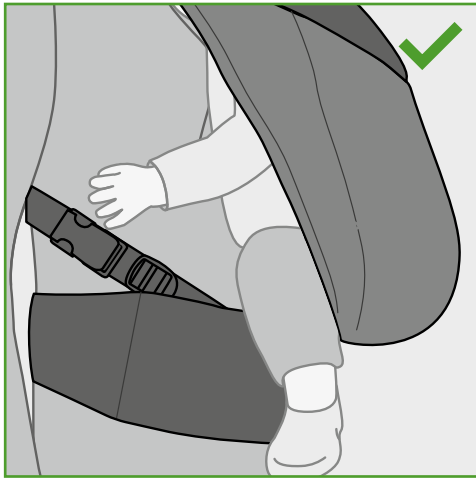

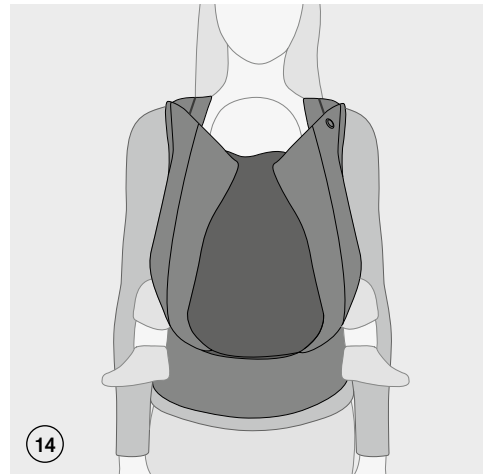

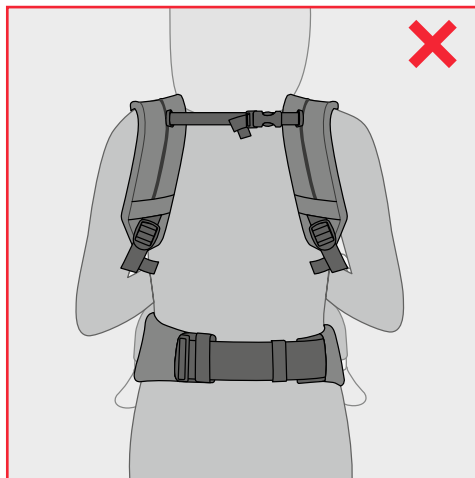
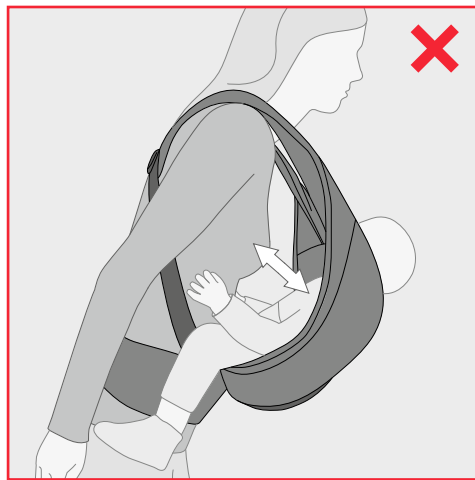
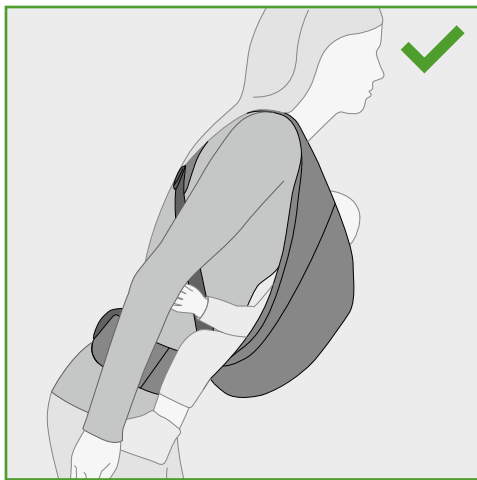

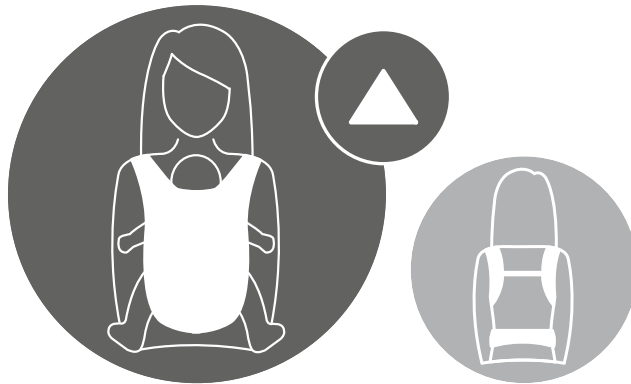

# **FRONT** CARRY PARALLEL

TAKE OUT THE BABY



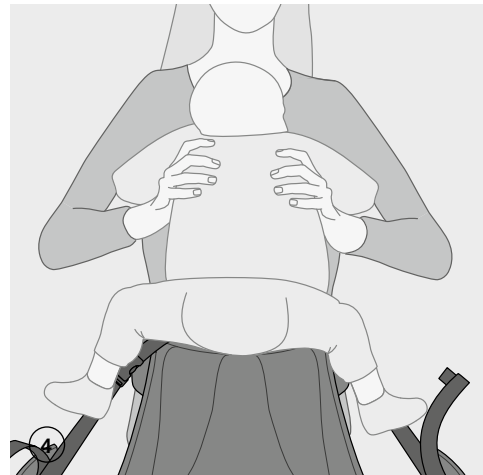
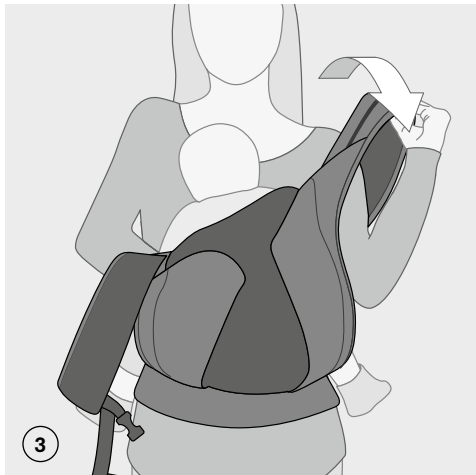
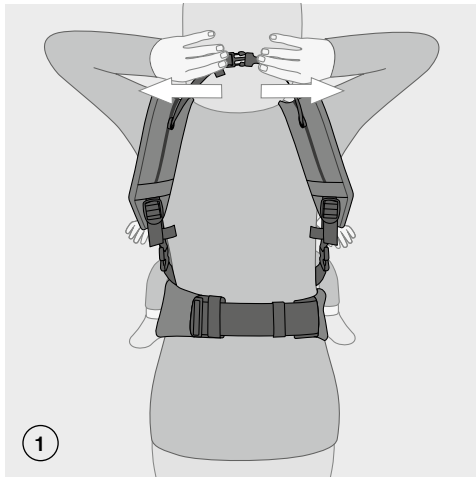

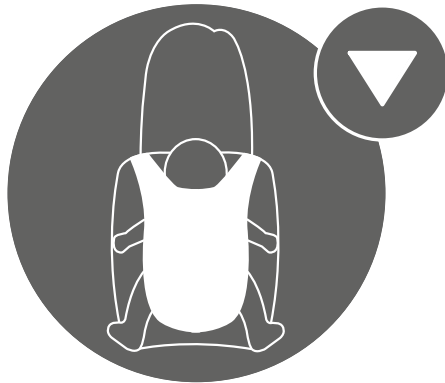

# **BACK** CARRY

PUT IN THE BABY



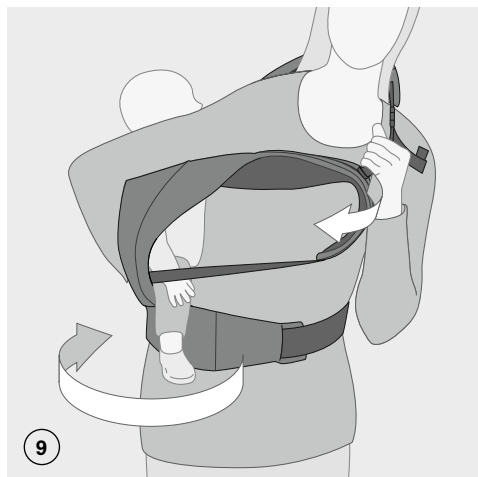

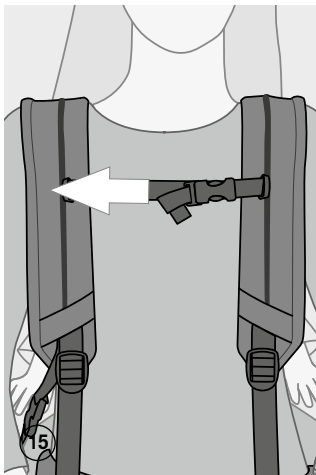
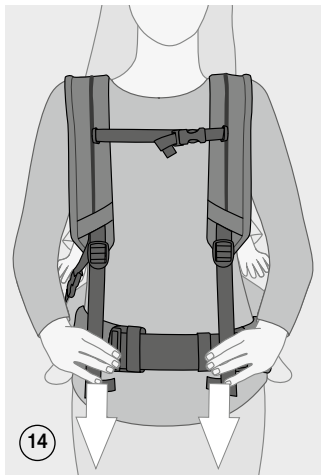



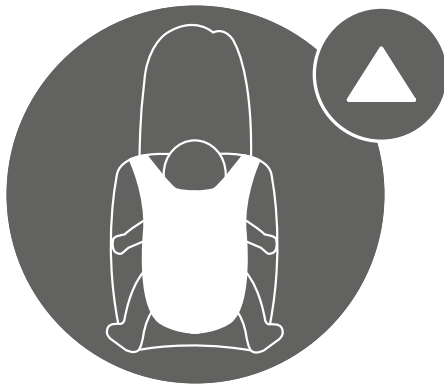

# **BACK** CARRY

TAKE OUT THE BABY

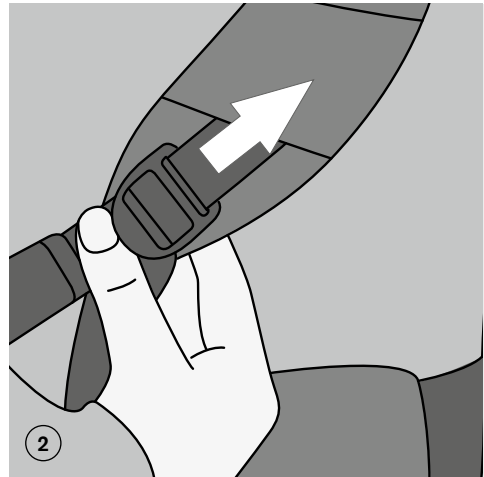
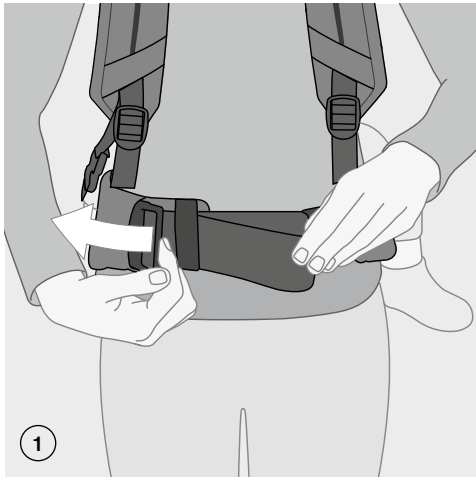



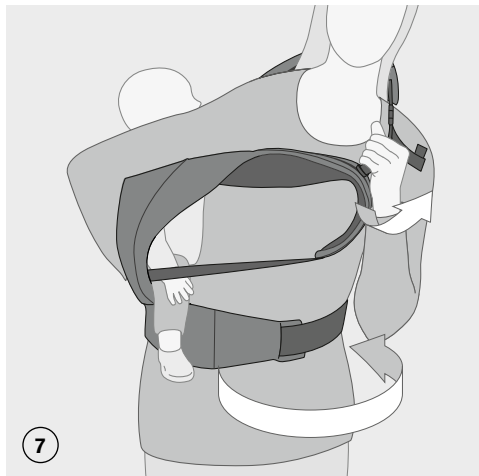

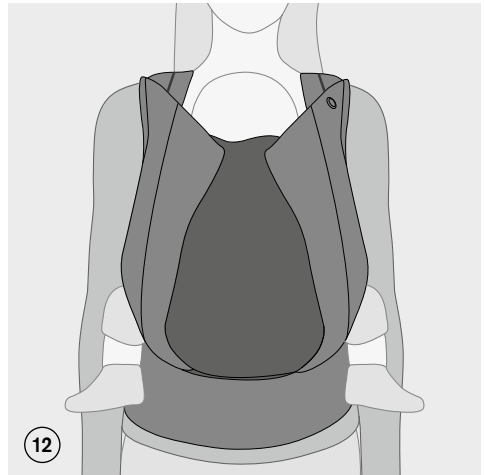
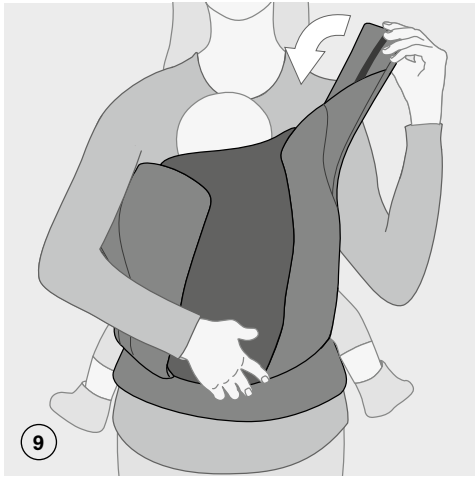

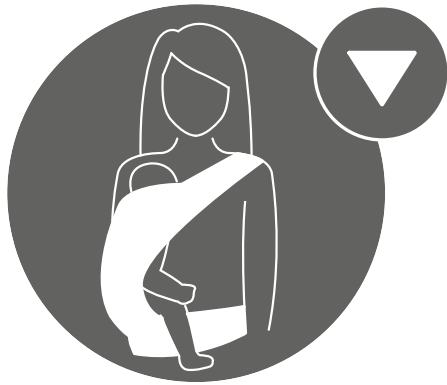

# **HIP** CARRY

PUT IN THE BABY

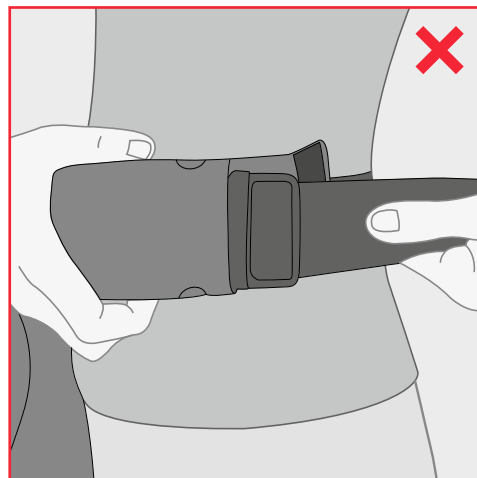
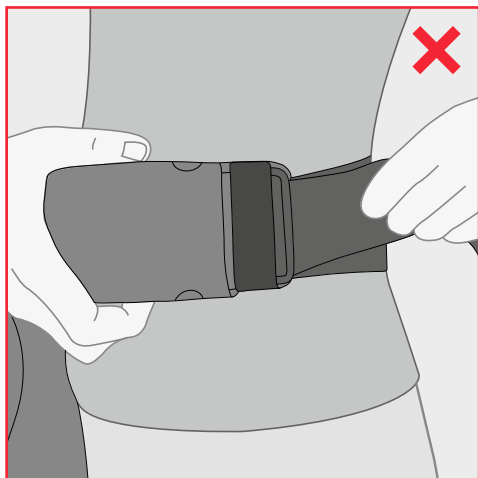
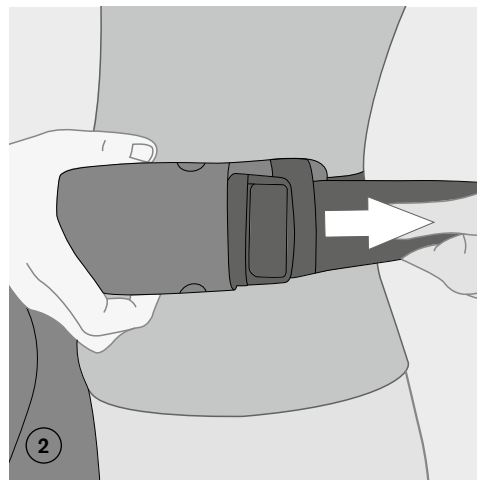
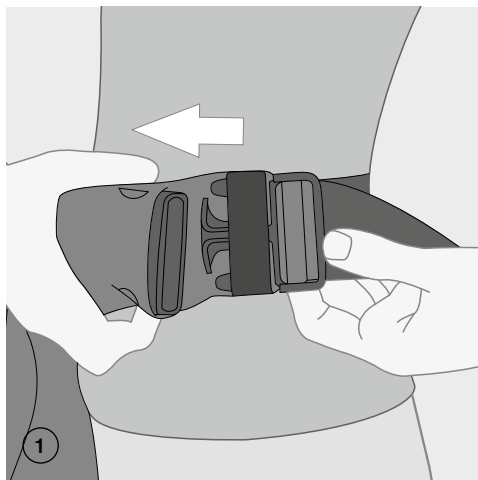

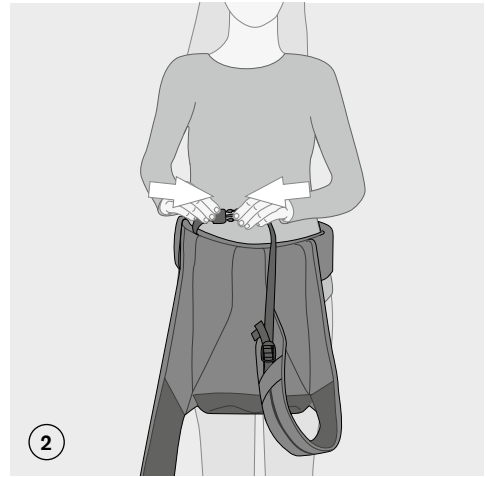
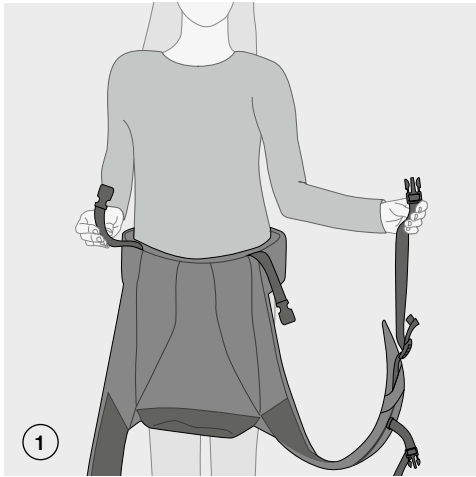



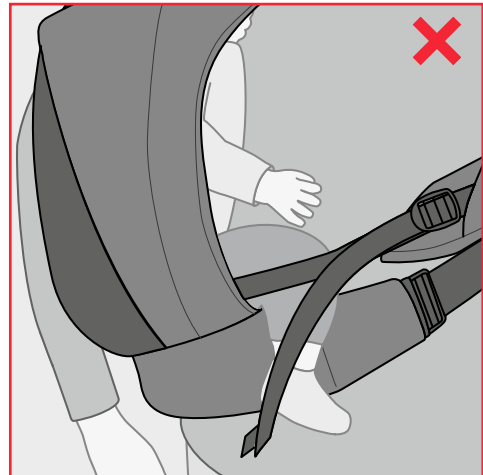
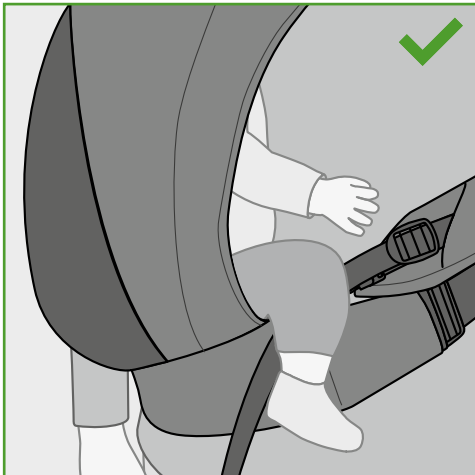
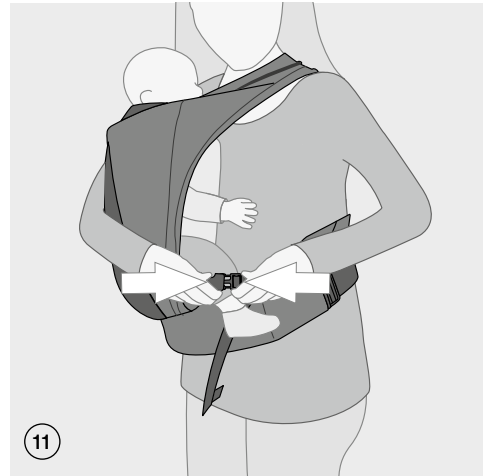
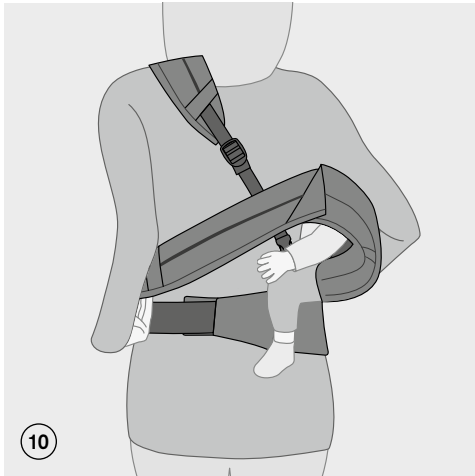

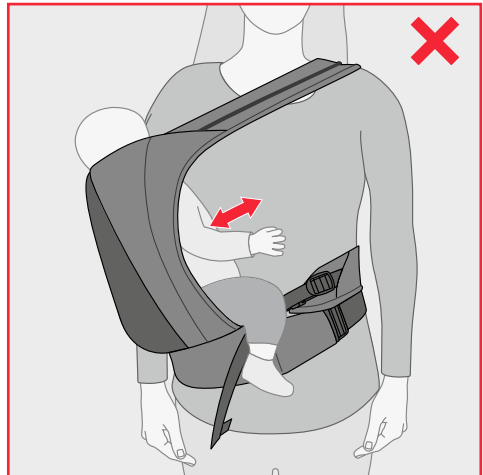
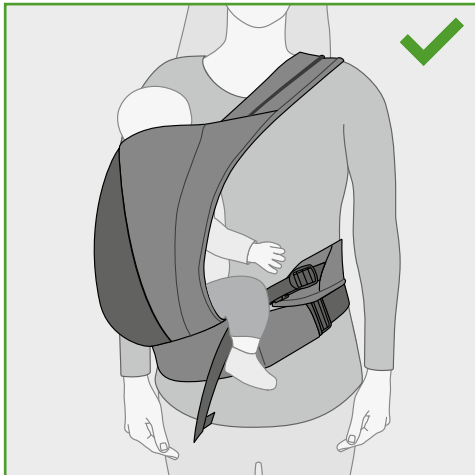
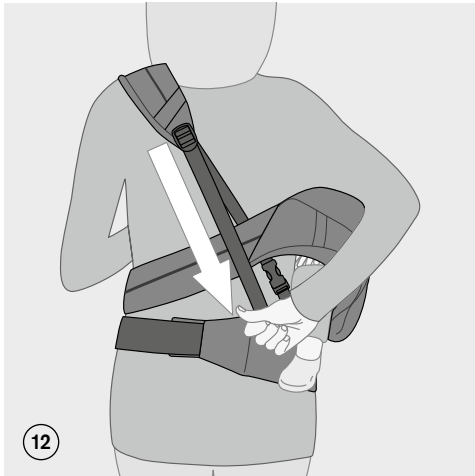





# **HIP** CARRY

TAKE OUT THE BABY

